

PRIMARY SCHOOL THIRD FLOOR AREA CHART

P1	= 1 X 14.630 X 17.460	= 255.878	SOMT
P2	= 1 X 7.350 X 4.850	= 35.647	SOMT
P3	= 1 X 10.570 X 4.560	= 48.199	SOMT
P4	= 1 X 5.055 X 2.830	= 14.305	SOMT
P5	= 1 X 36.230 X 7.430	= 269.188	SOMT
P6	= 1 X 29.750 X 7.460	= 221.935	SOMT
P7	= 1 X 1/27.015+2.830/20.375	= 100.295	SOMT
P8	= 1 X 7.435 X 2.830	= 20.941	SOMT
P9	= 1 X 1/27.365+6.945/20.375	= 20.533	SOMT
TOTAL (P1 to P9)		= 986.041	SOMT

DEDUCTION AREA

O1	= 1 X 2.100 X 1.900	= 3.990	SOMT
O2	= 1 X 6.970 X 7.200	= 50.184	SOMT
O3	= 1 X 0.750 X 4.030	= 3.023	SOMT
TOTAL (O1 to O3)		= 57.197	SOMT

NET COVD. AREA = (1-2)
986.041 - 57.155 = 928.886 SOMT.

PRIMARY SCHOOL TOTAL COVD. AREA ON ALL FLOORS =

S. NO.	FLOORS	TOTAL COVD. GROUND AREA	MUMTY & BACKCUT COVERAGE MACHINE RM
1.	BASMENT	102.869	SOMT.
2.	GROUND COVER	1051.295	SOMT.
3.	GROUND FLOOR	1059.556	SOMT.
4.	1st FLOOR	1002.401	SOMT.
5.	2nd FLOOR	1002.401	SOMT.
6.	3rd FLOOR	928.886	SOMT.
7.	MACHINE ROOM,	57.403	SOMT.
8.	MUMTY	28.456	SOMT.
TOTAL		= 3669.253	1092.265

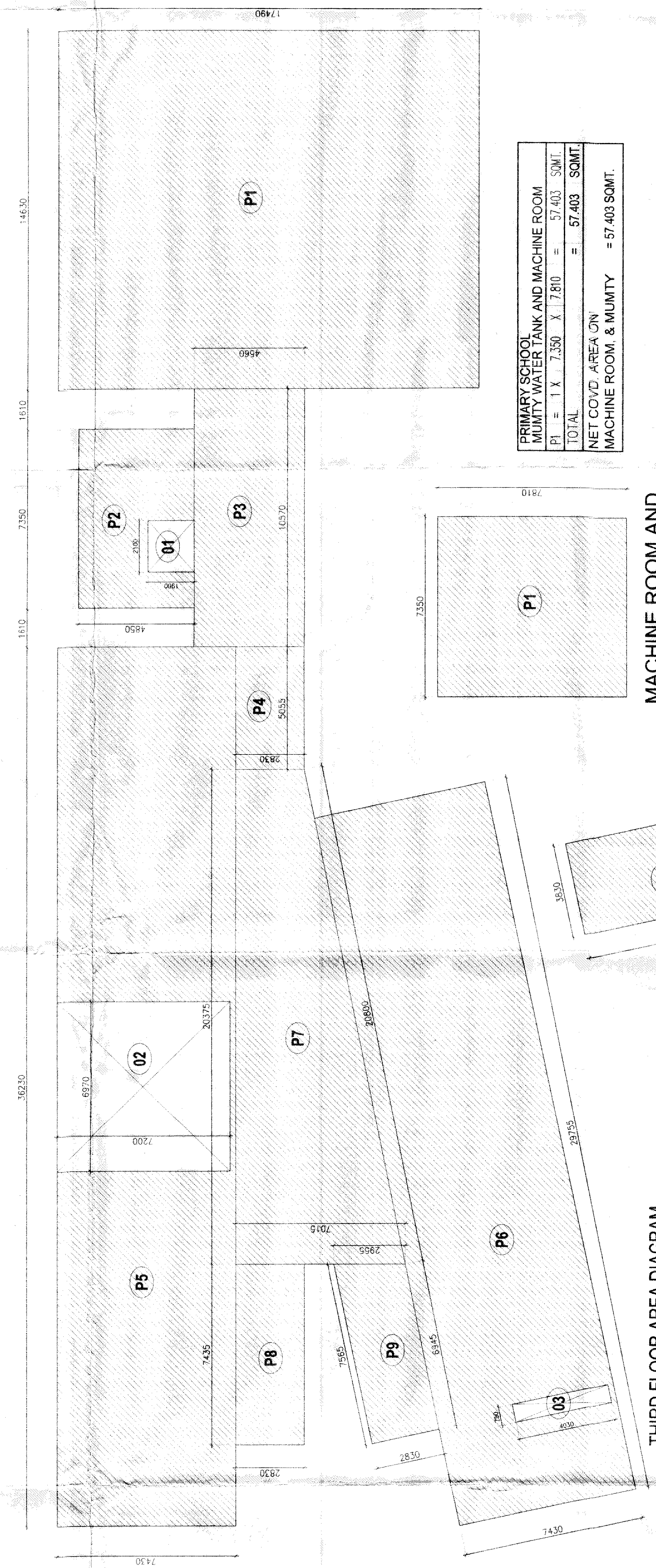
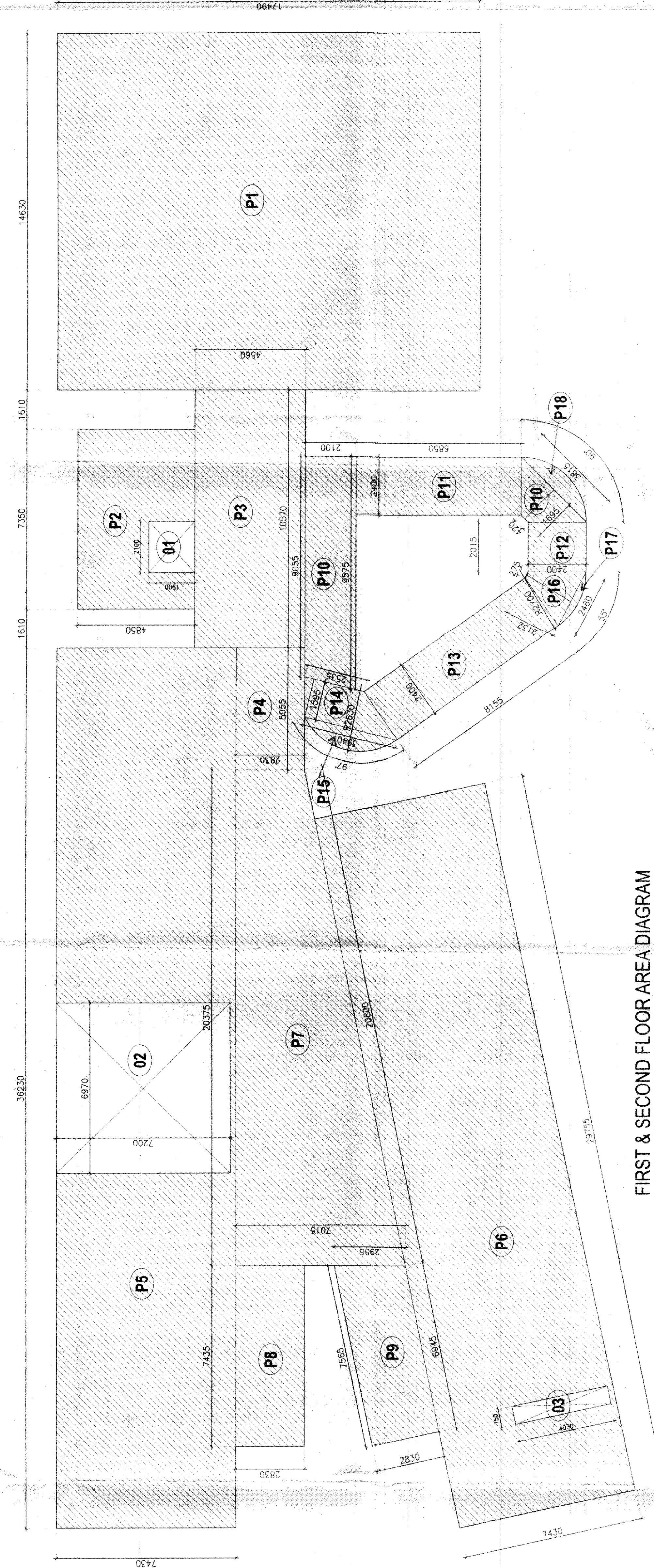

PRIMARY SCHOOL MUMTY AREA CHART

P1	= 1 X 14.630 X 17.460	= 255.878	SOMT
P2	= 1 X 7.350 X 4.850	= 35.647	SOMT
P3	= 1 X 10.570 X 4.560	= 48.199	SOMT
P4	= 1 X 5.055 X 2.830	= 14.305	SOMT
P5	= 1 X 36.230 X 7.430	= 269.188	SOMT
P6	= 1 X 29.750 X 7.460	= 221.935	SOMT
P7	= 1 X 1/27.015+2.830/20.375	= 100.295	SOMT
P8	= 1 X 7.435 X 2.830	= 20.941	SOMT
P9	= 1 X 1/27.365+6.945/20.375	= 20.533	SOMT
P10	= 1 X 1/29.055+5.975/20.100	= 16.440	SOMT
P11	= 1 X 2.405 X 2.400	= 5.760	SOMT
P12	= 1 X 2.405 X 2.400	= 5.760	SOMT
P13	= 1 X 1/23.940+2.535/5.965	= 4.036	SOMT
P14	= 1 X 1/23.940+2.535/5.965	= 4.036	SOMT
P15	= 1 X 1/27.480+0.925/21.12	= 2.419	SOMT
P16	= 1 X 1/27.480+0.925/21.12	= 2.419	SOMT
P17	= 1 X 1/27.480+0.925/21.12	= 2.419	SOMT
P18	= 1 X 1/27.480+0.925/21.12	= 2.419	SOMT
TOTAL (P1 to P18)		= 1059.556	SOMT

DEDUCTION AREA

O1	= 1 X 2.100 X 1.900	= 3.990	SOMT
O2	= 1 X 6.970 X 7.200	= 50.184	SOMT
O3	= 1 X 0.750 X 4.030	= 3.023	SOMT
TOTAL (O1 to O3)		= 57.197	SOMT

NET COVD. AREA = (1-2)
1059.556 - 57.155 = 1002.401 SOMT.

